

ROTA-S plus 2.0

Manual Lathe Chucks

Superior Clamping and Gripping



Product overview



Gripping Systems

Clamping Technology



Chuck Jaws



Stationary Workholding



Lathe Chucks



Toolholders



Hydraulic Expansion Technology



Manual Lathe Chucks



Power Lathe Chucks with Jaw Quick-change System



Power Lathe Chucks with Through-hole



Power Lathe Chucks without Through-hole



Pneumatic Power Chucks



Steady Rests



Quick-change Systems



Customized Solutions

Challenges

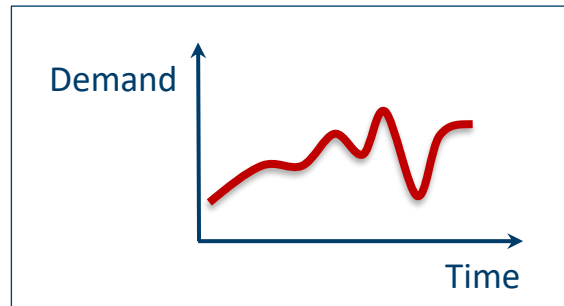
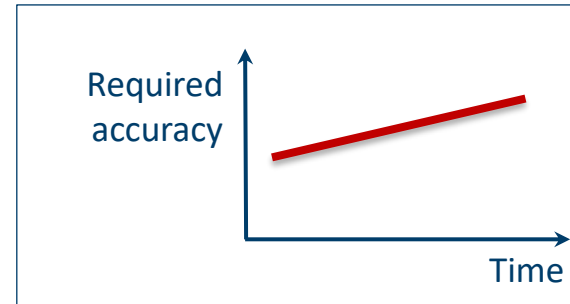
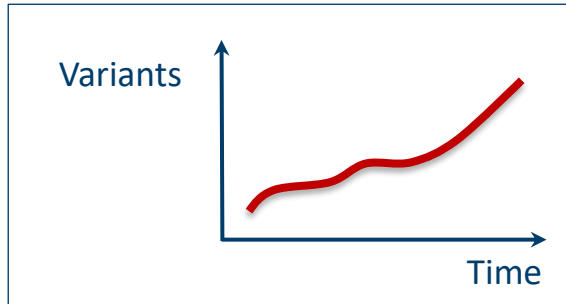

Flexibility and und set-up time optimization

ROTA overview

Manual Lathe Chuck

ROTA-S plus 2.0

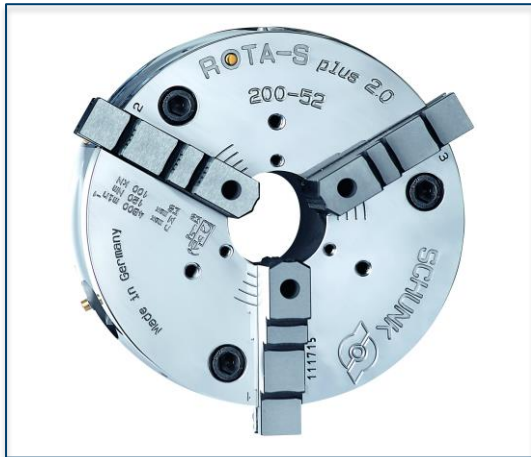

ROTA-S flex

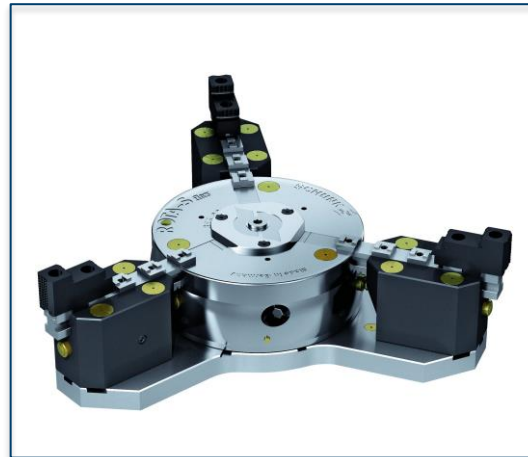

SPK



ROTA-S plus 2.0

Example of application

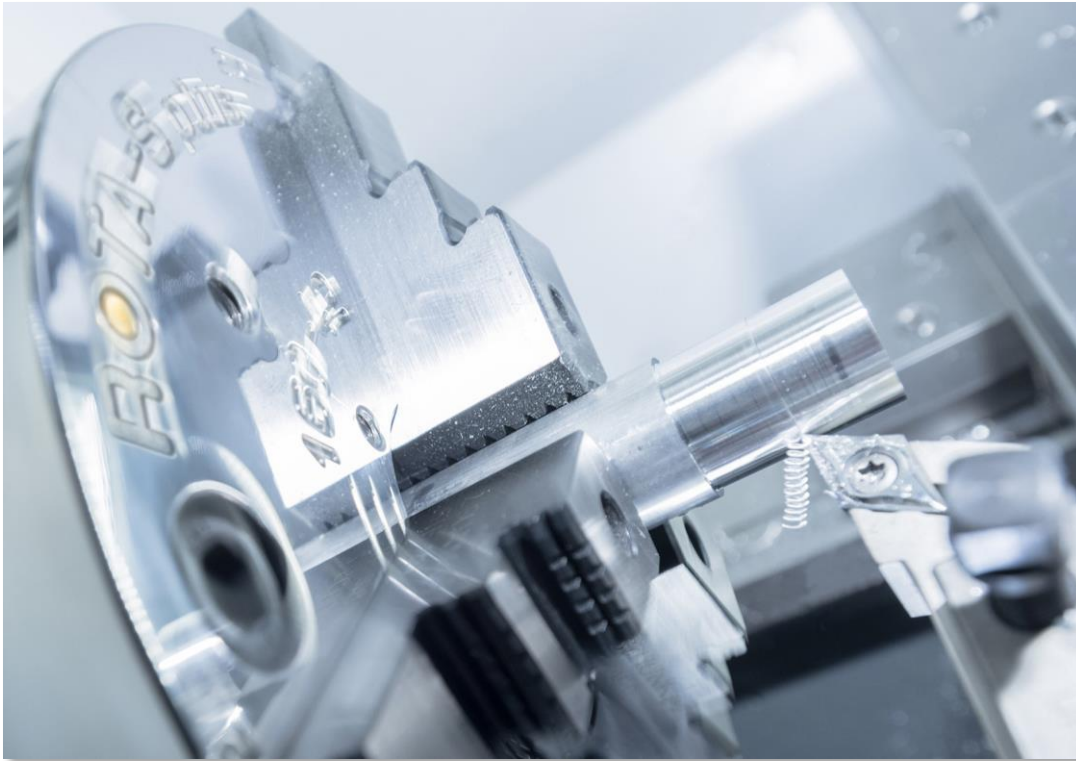

Clamping device:

ROTA-S plus 2.0 160 with stepped jaw.

Features/Application:

O.D. clamping of bars. Precise and safe clamping for best turning results. Easy and efficient retrofitting for changing diameter ranges with jaw quick-change.

ROTA-S plus 2.0

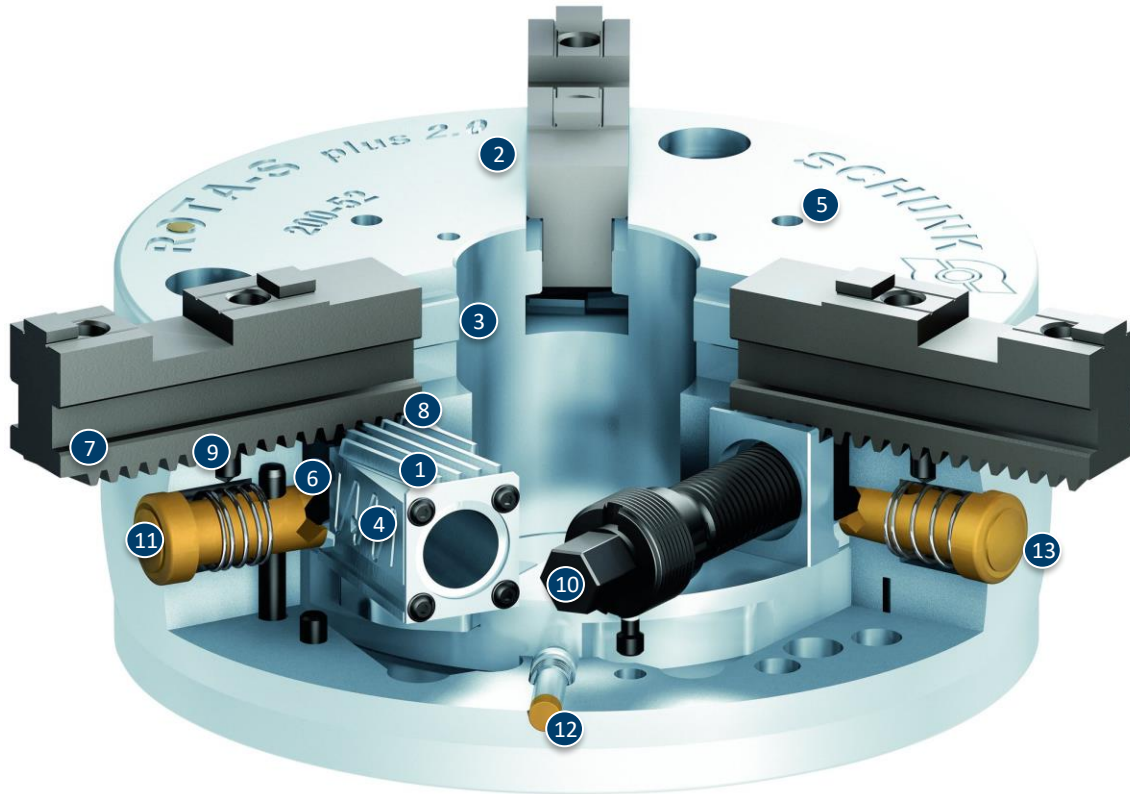

- ① Wedge bar actuation system
- ② Hardened and extremely rigid base body
- ③ Large through-hole
- ④ Optimized lubrication system
- ⑤ Mounting threads
- ⑥ Jaw quick-change system
- ⑦ Base jaw with angled serration (SFG)
- ⑧ Locking mechanism
- ⑨ The plunger pin
- ⑩ Operation via hexagon connection
- ⑪ Push button for jaw change
- ⑫ Indicator pin
- ⑬ Special shaping with „edge profile for coolant run-off“

ROTA-S plus 2.0

Modular Center Sleeve System

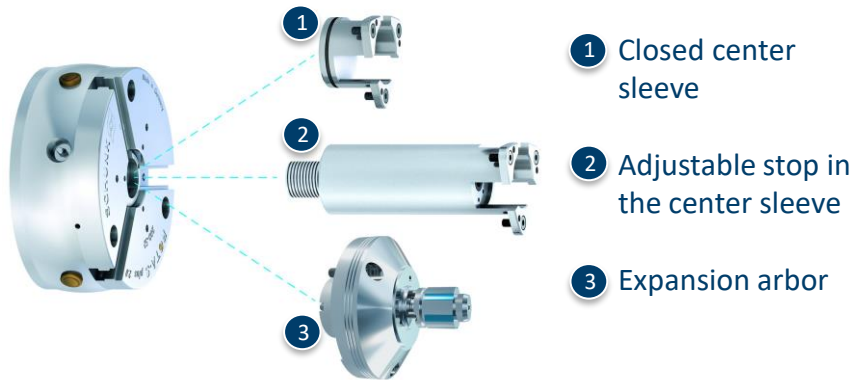

Spindle with hexagon connection



Wedge bar system with wiper



Central lubrication system

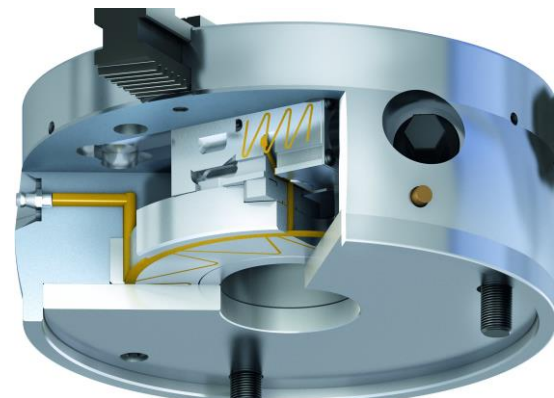

ROTA-S plus 2.0

Maximum operating safety

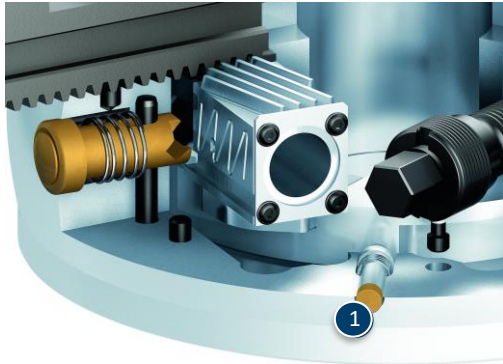

- 1 Indicator pin

Correct jaw change

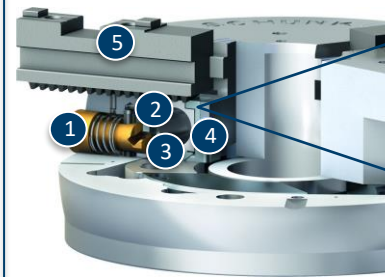

- 1 Push button
- 2 Slide
- 3 Traverse slide
- 4 Locking slide
- 5 Base jaw

Incorrect jaw change

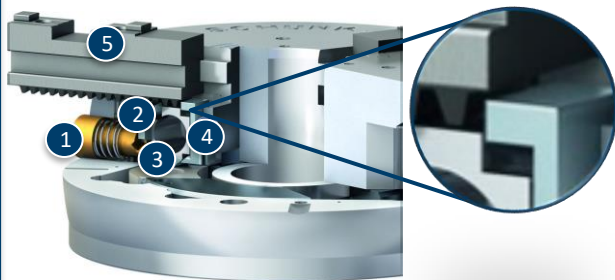

- 1 Push button
- 2 Slide
- 3 Traverse slide
- 4 Locking slide
- 5 Base jaw

Angle serrated base jaws

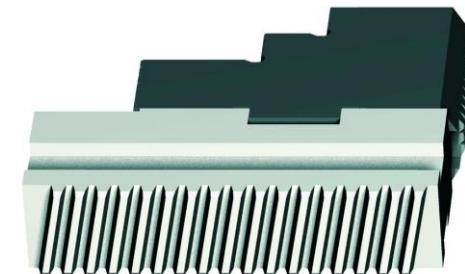

ROTA-S plus 2.0

vario M

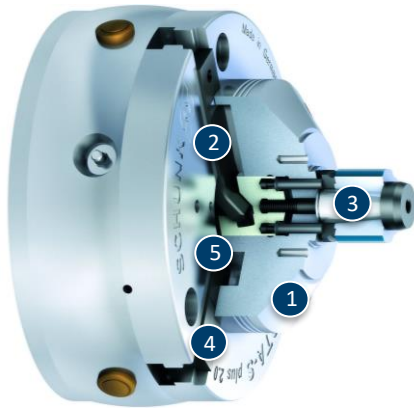

- 1 Expansion arbor
- 2 Actuating jaw with wedge hook drive
- 3 Clamping sleeve
- 4 Dummy jaw
- 5 Flex cone in the chuck bore

Expansion Arbor for I. D. Clamping



Easy Actuation of the Expansion Arbor

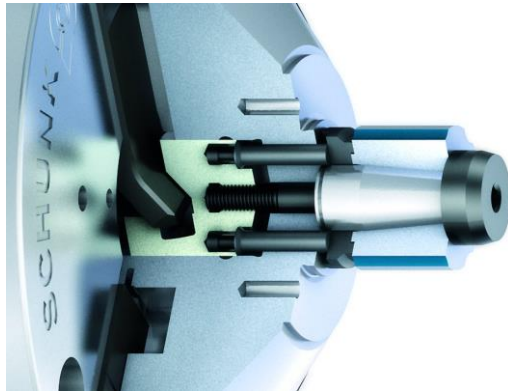

Indicator pin ROTA-S plus

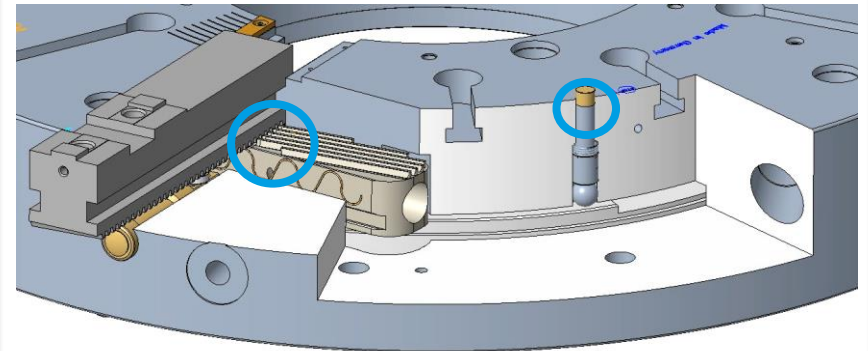

ROTA-S plus 2.0

Standardpaket

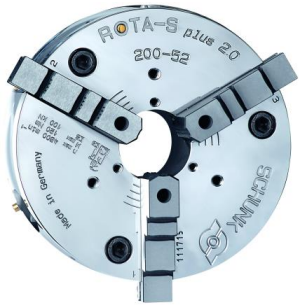

Chuck ROTA-S plus 2.0

Base jaws

Special Offer Package 1

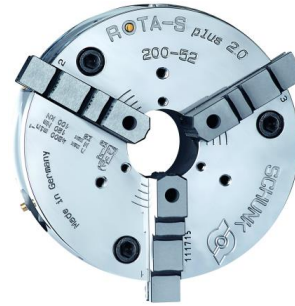

Chuck ROTA-S plus 2.0

Stepped block jaws
ground on the chuck

Special Offer Package 2

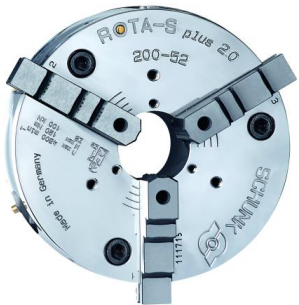

Chuck ROTA-S plus 2.0

Base jaws

Hard top jaws
ground on the chuck

Variants ROTA-S plus 2.0

Technical data	Max. RPM [min ⁻¹]	Max. clamping force [kN]	Max. torque [Nm]	Stroke/jaw [mm]	Through-hole (max. enlargement) [mm]
ROTA-S plus 2.0 160-42	5400	65	80	6.5	42 (45)
ROTA-S plus 2.0 200-52	4800	100	120	7	52 (55)
ROTA-S plus 2.0 250-62	4200	160	210	7.5	62 (75)
ROTA-S plus 2.0 315-92	3400	180	220	9.7	92 (102)
ROTA-S plus 400-102	2200	230	280	12	102 (130)
ROTA-S plus 500-162	1500	270	320	12	162 (180)
ROTA-S plus 630-252	1000	270	350	15	252 (270)
ROTA-S plus 800-252	1000	270	350	15	252 (270)
ROTA-S plus 1000-402	900	270	350	15	402 (412)

Technical data	Max. clamping force [kN]	Clamping range [mm]
vario M0	42	20-28
vario M1	42	26-38
vario M2	85	36-54
vario M3	105	50-80

SCHUNK Services



Engineering

- Dimensioning of special plates designed to the manufacturing specifications
- Development of special solutions together with the customer
- FEM analysis for critical components

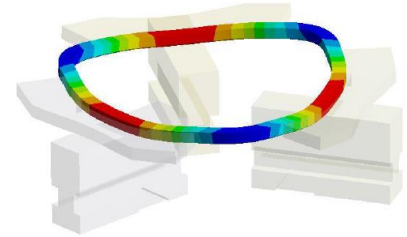

Testing

- Endurance tests with all new developments
- Abrasion checking
- Measurement of accuracy

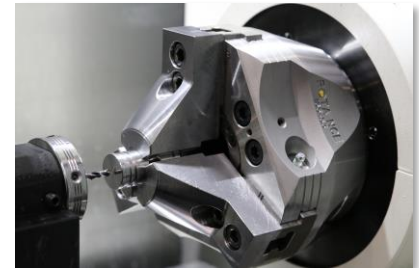

Service

- Initial operation of customer's solution
- Inspection and maintenance
- Repairs



Superior Clamping and Gripping



© 2021 SCHUNK GmbH & Co. KG
schunk.com