



# KONTEC KSX vs. Hoffmann XPENT

## Sales Information

Superior Clamping and Gripping



# KSX vs. XPENT



# KSX vs. XPENT

## Packing & Scope of delivery



KONTEC KSX incl. Clamping lever,  
Hand crank and clamping claws



XPENT incl. Clamping lever

**High quality wooden box for KSX, Cardboard box for XPENT**  
**Additional costs for clamping claws and torque wrench for XPENT (250 Euro)**

# KSX vs. XPENT

## Handling

	Length (mm)	Weight (KG)	+   -
XPENT	450	39	Warning against to raise with spindle
KSX	300	30	Fast and easy transportation

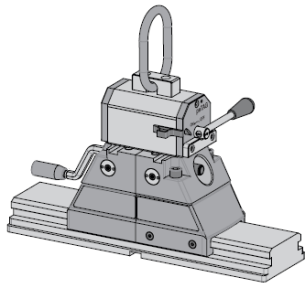

Magnetic lift

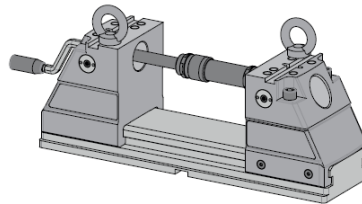

Crane eyes

- Always remove the support jaws first
- Handling only by magnetic lift or crane eyes

# KSX vs. XPENT

## Handling

	Length (mm)	Weight (KG)	+   -
XPENT	450	39	Warning against to raise with spindle
KSX	300	30	Fast and easy transportation



Warning at XPENT  
→ Do not raise with spindle !



Robust KONTEC KSX  
→ Easy handling !

# KSX vs. XPENT

## Installation I Liability

SCHUNK applies for a direct installation on VERO-S

- Absolut expedient –

Hoffmann enjoins from doing this !

### 5.6 Mounting on zero point clamping systems



**CAUTION!** Improper use may lead to damage to the vice or zero point clamping system. The Hoffmann Group accepts no liability for direct mounting on the zero point clamping system.

- ▶ In order to exclude damage the use of an adapter plate is recommended in order to enlarge the mounting area and improve stability.
- ▶ If you have any questions please contact Hoffmann field service.



# KSX vs. XPENT

## Version

	Clamping force (kN)	Jaws (mm) width   height	Bas body length (mm)	Clamping range (mm)	+   -
XPENT Vers. 0	30	100   165	360, 440, 520	6 – 301 (at length 360)	Clamping by torque wrench
KSX low	40	125   165	265, 300	6 - 250	Amplified force clamping
XPENT Vers. 1	40	125   210,5	450, 550, 650, 850, 1050	6 – 386 (at length 450)	Clamping by torque wrench
KSX	40	125   214	300, 550, 800, 815	0 - 250	Amplified force clamping

# KSX vs. XPENT

## Installation

### XPENT

- Sideway clamping claws
- Zero-Clamp
- Installation through the base body on request
- Additional cost for mounting plate for GARANT Zero-Clamp (1.350 – 1.750 Euro I recommended by Hoffmann)



### KSX

- Sideway clamping claws
- Direct installation on VERO-S and Gredoc
- Installation through the base body is standard



# KSX vs. XPENT

## Spindle

### XPENT

- Spindle completely open
- Extensive clamping by torque wrench
- Maintenance rate 50 h
- Catalogue inscription of Repeatability : < 0.01 mm



### KSX

- Encapsulated spindle and userfriendly 160° force transmission
- No specific maintenance
- Repeatability: +- 0.01mm

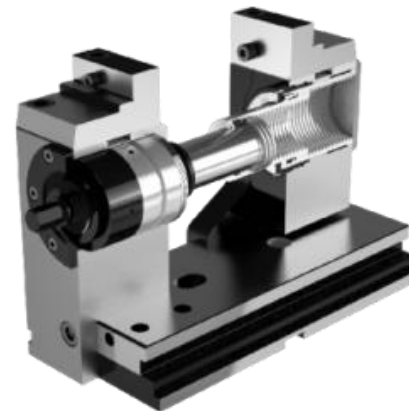

# KSX vs. XPENT

## Modification from standard to VS position

### XPENT

Turning of both clamping modules.  
Change of both system jaws. For this the spindle must be completely dismantled (set-up time + costs)



### KSX

Turning of jaws, ready !

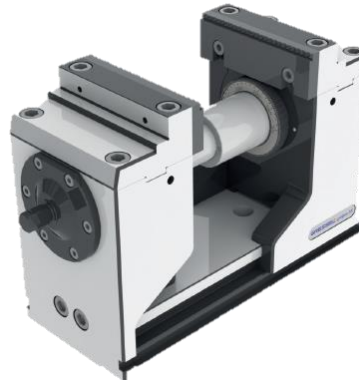

# KSX vs. XPENT

## Accessibility standard clamping range

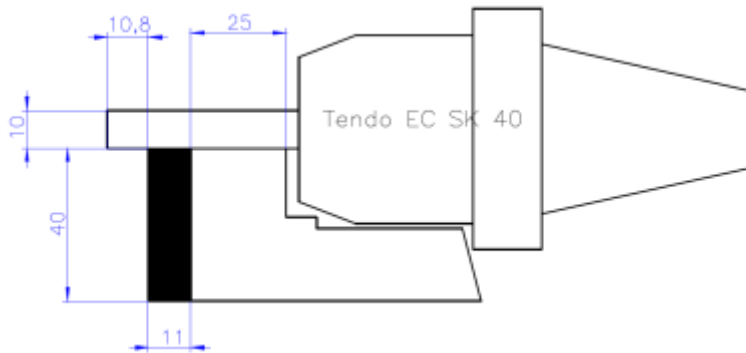

### KSX standard jaw position

Machining length of tool: 10.8mm

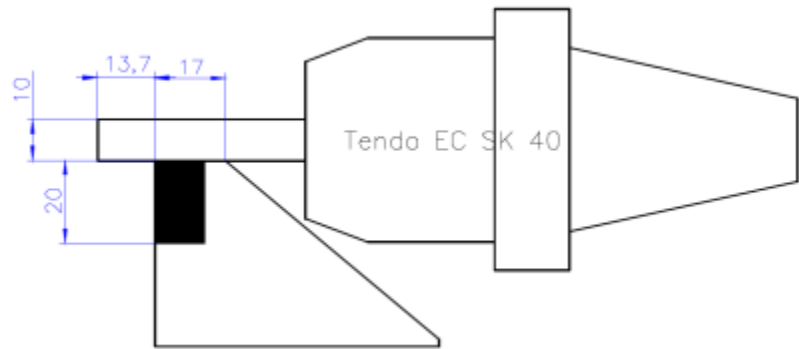

### XPENT standard jaw position

Machining length of tool: 13.7mm

# KSX vs. XPENT

## Accessibility clamping range VS position

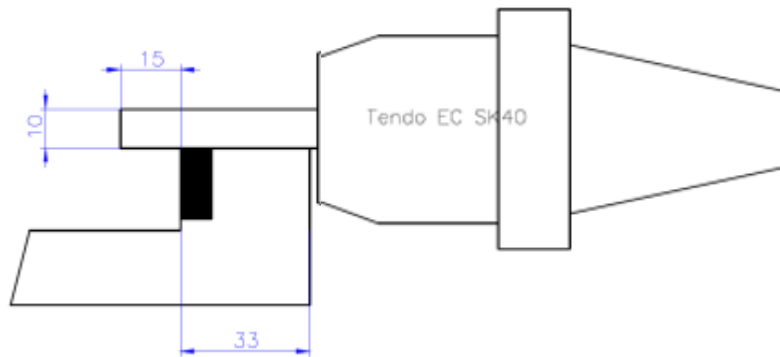

### KSX standard jaw position

Machining length tool: 15mm

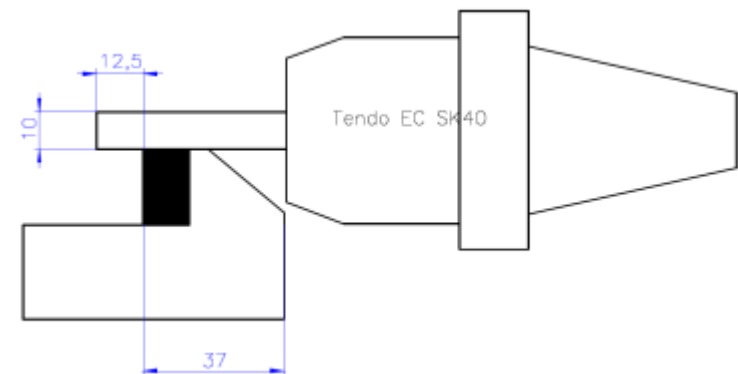

### XPENT standard jaw position

Machining length tool: 12.5mm

# KSX vs. XPENT

## System jaws

### XPENT

- 4 x System jaws 125 mm for the complete clamping range  
Euro 1.180



System jaws mounting by 2 x M12  
Top jaw mounting by 1 x M6  
→ Tilting danger while mounting

### KSX

- 2 x System jaws 125 mm for the complete clamping range  
Euro 660,00



System jaws mounting by 4 x M12  
Top jaw mounting by 2 x M8

# KSX vs. XPENT

## Prices

	XPENT 1	XPENT 0	KSX	KSX niedrig
Vise	2.725	2.425	2.786	2.601
Top jaw standard	590	590	660	660
Top jaw twisted	590	590	Inkl.	Inkl.
Clamping claws	68	68	Inkl.	Inkl.
Crank	Inkl.	Inkl.	Inkl.	Inkl.
Torque wrench	185	185	-	-
	4.158	3.858	3.446	3.261

### Attention in comparison of prices:

Hoffmann is in need of 4 system jaw, not only 2 (plus torque wrench and wrench socket) for the same performance

# KSX vs. XPENT

## Warranty

	Warranty
XPENT	1 year
KSX	2 years

# KONTEC KSX-C

**KONTEC KSX-C | New and for the first time ever live on EMO**



**The proved 5-axis clamping vise  
with continuously variable fixed jaw.**

# KONTEC KSX-C

Fast and easy modification of the clamping range

## 2 Drawbar extension Quick change system

- Enlargement of clamping range
- Fast modification and safety locking by cotter

## 1 Levered-quick clamping With hexagon socket

- clamping < 1 second
- no torque wrench
- Perfect accessibility

## 3 Open the screws and twist the system jaws

## 4 Multifunctional applications

- 7 different system jaws
- New 5A-jaw
- 25 different top jaws

## 5 Complet encapsulated and Quick clamping

- Dirt-resistand, smoothly running force transmission

## 6 Declamp of the mobile fixed jaw

- Displacing of both jaws
- 1 screw clamping at mobile fixed jaw

## 8 3 variations

- Base body L= 430 mm
- Base body L= 500 mm
- Base body L= 630 mm

## 7 Laser scale

- Easy positioning of the jaws

NEW

NEW

NEW

NEW

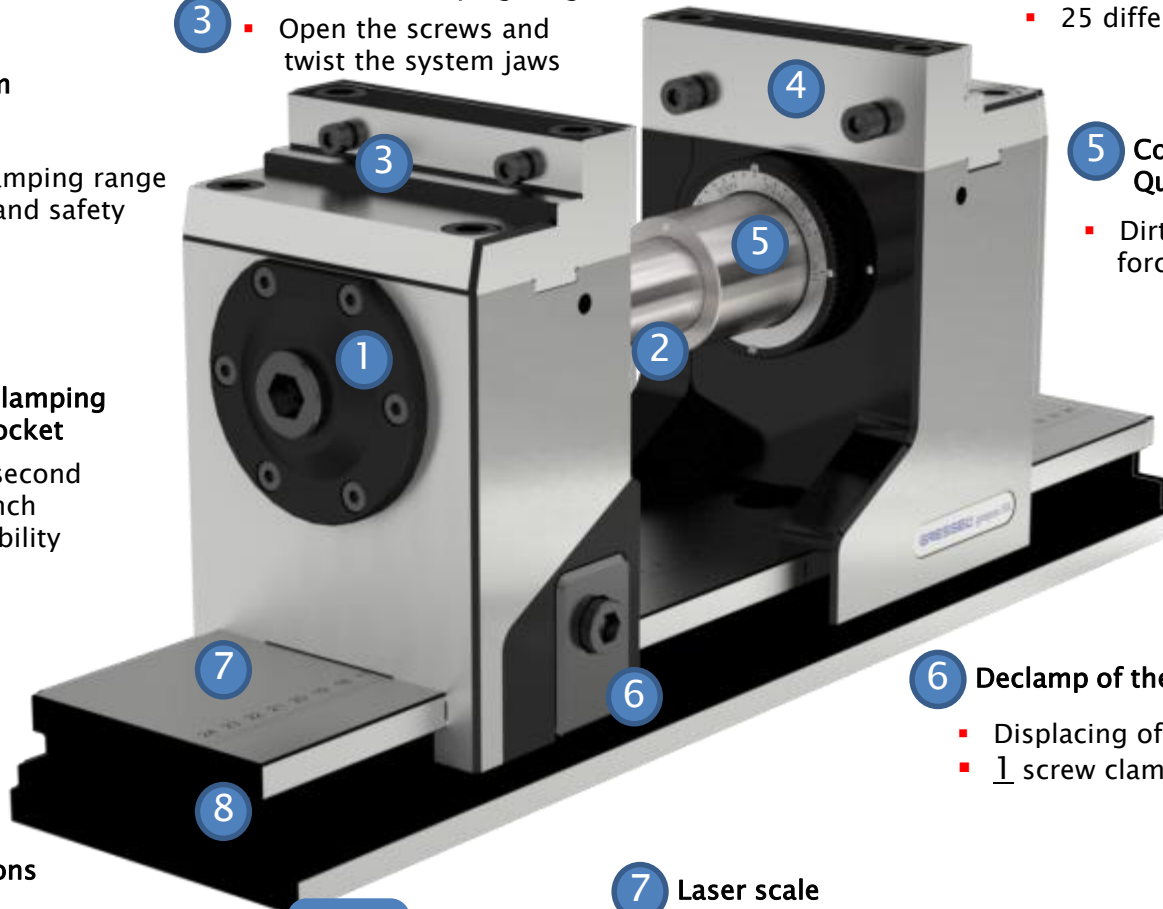

# KONTEC KSX-C

## Innovation I Declamp of the mobile fixed jaw

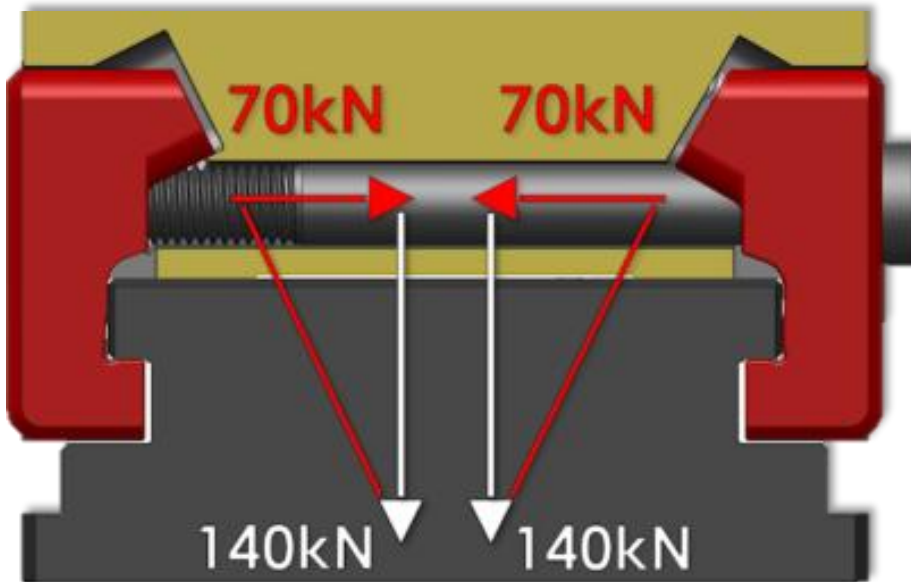

Customer query: fixed by only 1 screw – is this safe ?

Answer: Yes, the holding force of the fixed jaw is nearly identical as the KSX force (with 4 screws)  
(double effective screw = double holding force Kraft) | (inclined surface = double force)

# KONTEC KSX-C

NEW

Accessibility with standard top jaw

Accessibility with 5A Top jaw 125mm

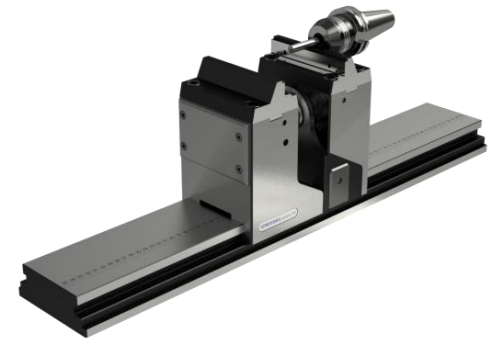
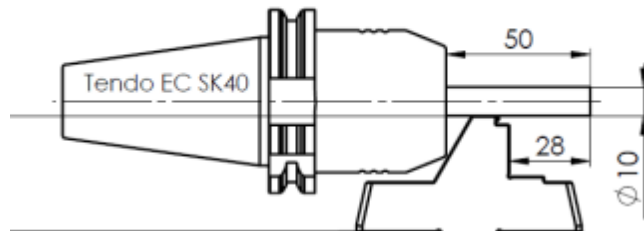

# KONTEC KSX-C

## Mounting

With clamping claws

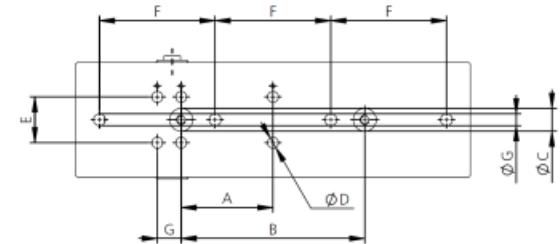

With clamping bolts

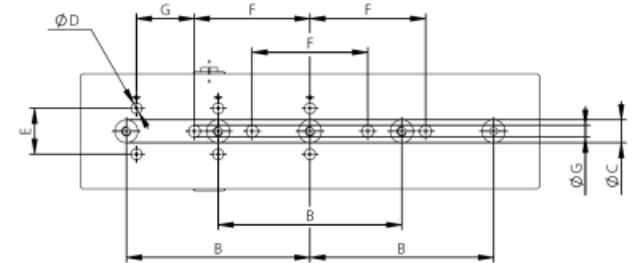

With centering set and screws through the base body

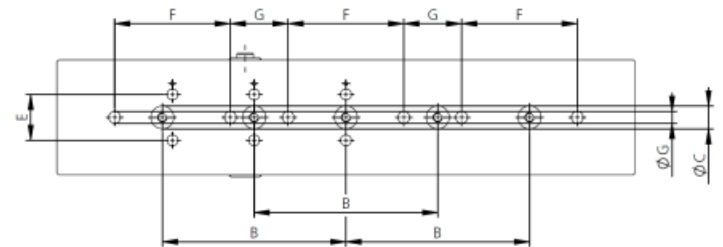
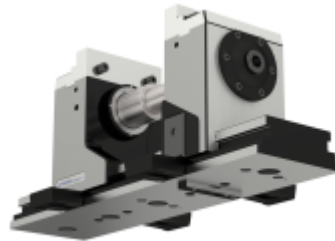

# KONTEC KSX-C

## KSX I KSX-C Workpiece position

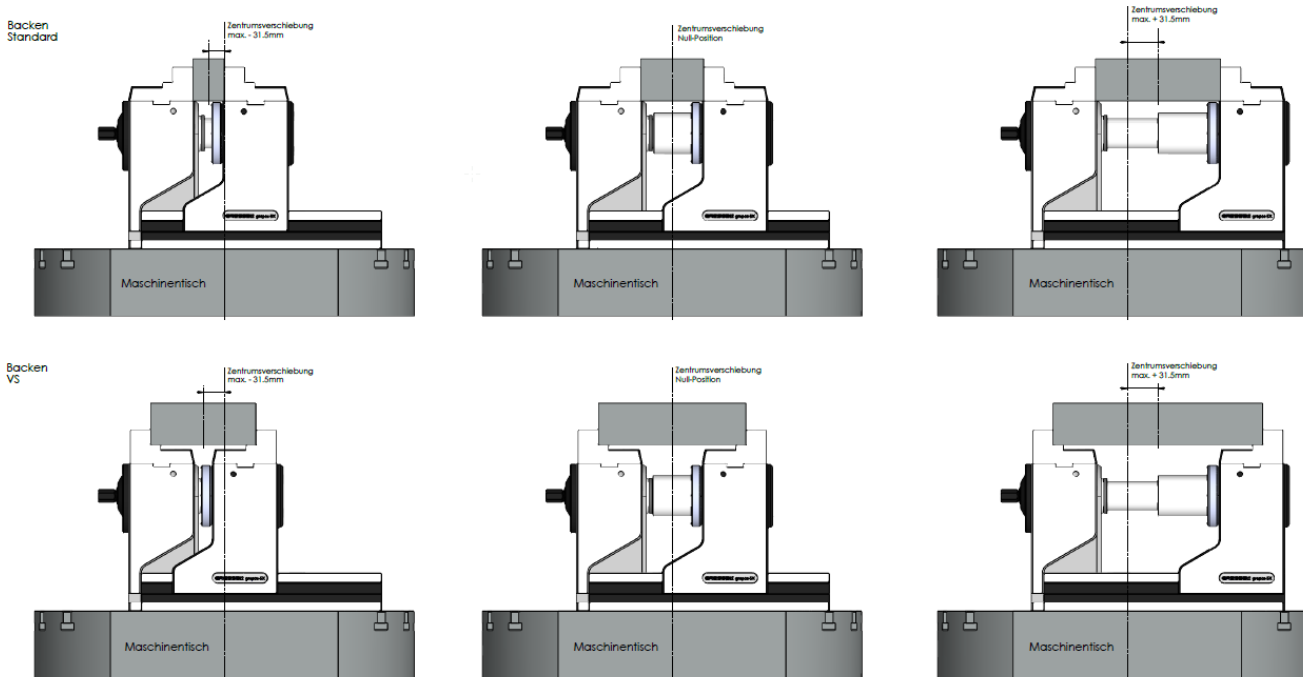

Clamping Vise L=300mm and jaws in standard and VS position

The pros outweigh the cons of the fixed jaw:

- Always in same position
- Minimal displacement of the center

# KONTEC KSX-C

## KSX application

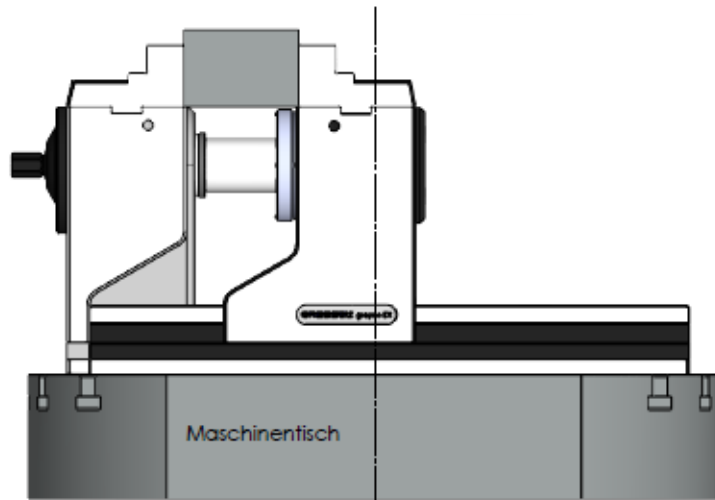

Big machine tables and small workpieces

Advantages:

- Always in same position
- One side accessibility

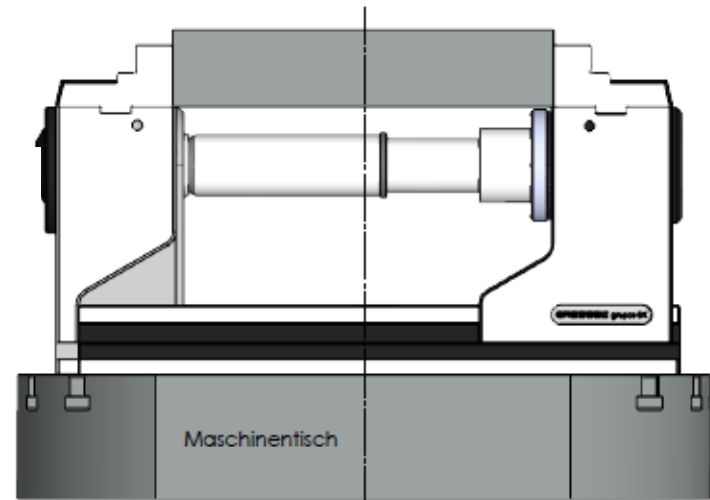

Big machine tables with large workpieces

Advantages:

- Always in same position
- Both side accessibility

# KONTEC KSX-C

## KSX-C application

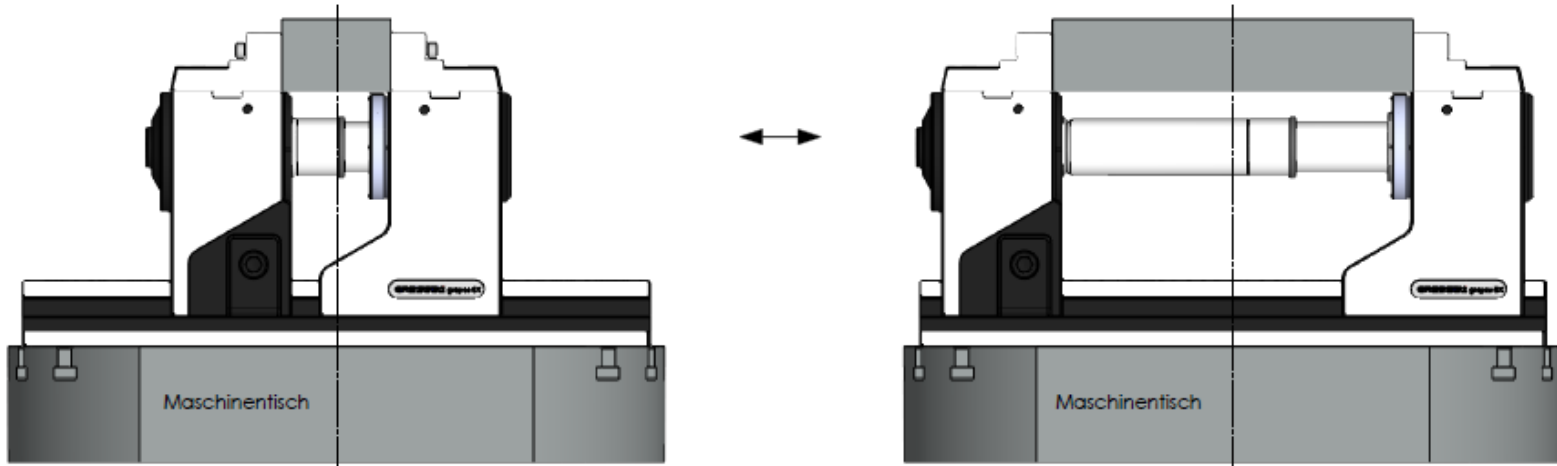

Big machine tables with small workpieces

Advantages:

- Central adjustment to the machine centre
- Better while 5A interpolate milling
- Higher flexibility in changing of bigger and smaller parts

Big machine tables with large workpieces

Advantages:

- Central adjustment to the machine centre
- Both side accessibility
- Higher flexibility in changing of bigger and smaller parts

## Mountings

**DMC 60 H linear 500x500**  
mit KONTEC KSX-C L-500



**DMC 60 H linear 500x500**  
mit 2x KONTEC KSX-C L-500



**DMC 80 H linear 630x630**  
mit KONTEC KSX-C L-630



**DMC 80 H linear 630x630**  
mit 2x KONTEC KSX-C L-500



**DMU 65 monoBLOCK Ø650**  
mit KONTEC KSX-C L-630



**DMU monoBLOCK Ø650**  
mit 2x KONTEC KSX-C L-500



**DMU 75 monoBLOCK Ø650**  
mit KONTEC KSX-C L-630



**DMU 75 monoBLOCK Ø650**  
mit 2x KONTEC KSX-C L-500



# KONTEC KSX-C



## Mountings

**HERMLE C22 Ø450x360**  
mit KSX-C L-430



**HERMLE C32 Ø450x360**  
mit KSX-C L-430



**HERMLE C32 Ø650x540**  
mit KSX-C L-630



**HERMLE C32 Ø650x540**  
mit 2x KSX-C L-500



**HERMLE C42 Ø420**  
mit KSX-C L-430



**HERMLE C42 Ø440**  
mit KSX-C L-430



**HERMLE C42MT Ø750**  
mit KSX-C L-630



**HERMLE C42MT Ø750**  
mit 2x KSX-C L-630



**HERMLE C42 Ø800x630**  
mit KSX-C L-630



# KONTEC KSX-C



## Mountings

**GROB G-350 Ø570**  
mit KSX-C L-500



**GROB G-350 Ø570**  
mit KSX-C L-500



**GROB G-550 630x630**  
mit KSX-C L-630



**GROB G-550 630x630**  
mit KSX-C L-630



# KSX vs. XPENT

## Prices

	KSX low L300	KSX-C L430	KSX-C L500	KSX-C L630	XPENT 0 L362	XPENT 1 L454	XPENT 1 L520	XPENT 1 L650
Vise	2.601	3.193	3.344	3.625	2.425	2.725	2.940	3.135
Top jaw standard	660	660	660	660	590	590	590	590
Top jaw twisted	Inkl.	Inkl.	Inkl.	Inkl.	590	590	590	590
Clamping claws	Inkl.	58	58	58	68	68	68	68
Crank	Inkl.	On demand	On demand	On demand	Inkl.	Inkl.	Inkl.	Inkl.
Torque wrench	No need	No need	No need	No need	185	185	185	185
Total package	3.261	3.911	4.062	4.343	3.858	4.158	4.373	4.568

# KSX vs. XPENT

## Project comparison: customer has need for 24 vises

Hoffmann XPENT	Price	Quantity	Price	SCHUNK KSX-C	Price	Quantity	Price
Basic bar 550 Special	1.210,00 €	24	29.040,00 €	Vise 500 Special	3.344,00 €	24	80.256,00 €
Clampig Module fix	890,00 €	24	21.360,00 €	Extension	306,00 €	24	7.344,00 €
Clamping Module movable	620,00 €	24	14.880,00 €	Extension 2	357,00 €	24	8.568,00 €
Spindle TR 16	295,00 €	24	7.080,00 €	Top jaw Standard	330,00 €	48	15.840,00 €
Extension 1	130,00 €	24	3.120,00 €	Stepped jaw grip 8	116,00 €	48	5.568,00 €
Extension 2	250,00 €	24	6.000,00 €	Positioning bar	38,00 €	48	1.824,00 €
Extension 3	385,00 €	24	9.240,00 €	Top jaw 65	330,00 €	48	15.840,00 €
Top jaw Standard 125	295,00 €	40	11.800,00 €	Jaw slick 65	59,00 €	48	2.832,00 €
Top jaw twisted 125	295,00 €	40	11.800,00 €	Total			138.072,00 €
Top jaw width 63	285,00 €	40	11.400,00 €				
Facing jaw 63 grip 3/3	80,00 €	40	3.200,00 €				
Facing jaw 63 slick 3/5	80,00 €	40	3.200,00 €				
Kombi facing jaw grip/slick	145,00 €	40	5.800,00 €				
Total			137.920,00 €				

# Market introduction

## Brochure



KONTEC KSC Modular System



KONTEC KSX-C

# FAQs

## **For the longer versions of the KSX-C, why is the crank not included and only on demand?**

Because of the hexagon socket in the new vise another clamping lever is included that has a hinge which allows to clamp and crank. Therefore, no additional crank is needed. But if the customer prefers a crank, it can be purchased as accessory.

## **Was there a comparison of the flatness of the two products?**

The flatness of the two products is almost identical.

Superior Clamping and Gripping

**SCHUNK** ®

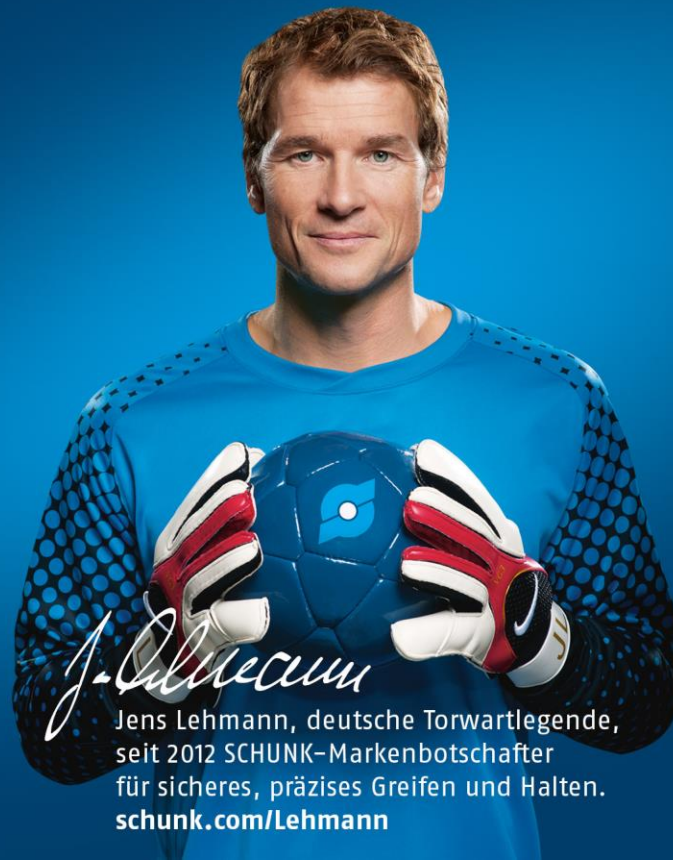

*J. Lehmann*

Jens Lehmann, deutsche Torwartlegende,  
seit 2012 SCHUNK-Markenbotschafter  
für sicheres, präzises Greifen und Halten.  
[schunk.com/Lehmann](http://schunk.com/Lehmann)

