



*your reliable partner*

Piston rod brake

---

ROBA<sup>®</sup>-linearstop electrical  
Type 382.000.0  
Size 10, 20

---

Issue status 2021-03

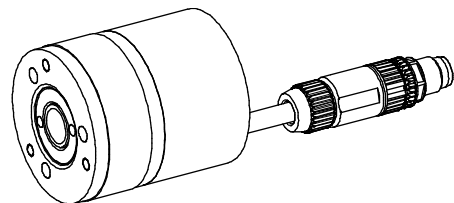
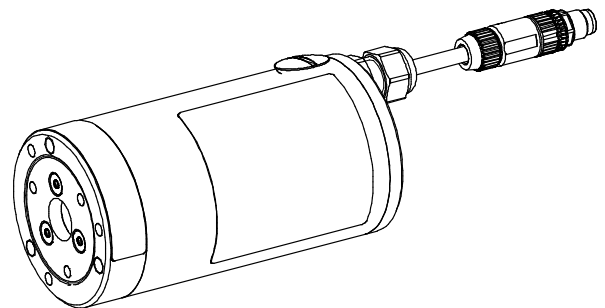

## Installation and Operational Instructions

E093 20 000 000 4 EN

---

© Copyright by mayr<sup>®</sup> – power transmission

All rights reserved.

Reprints and copies – even extracts – are only permitted with the consent of the manufacturer.

Design according to  
Drawing number: E09310000000313, E093 20 000 000 310  
Article number: 8256282, 8257878

**Please read these Operational Instructions carefully and follow them accordingly!**

Ignoring these Instructions may lead to malfunctions or to brake failure, resulting in damage to other parts. These Installation and Operational Instructions are part of the brake delivery.  
Please keep the Installation and Operational Instructions handy and near to the brake at all times.

**Contents**





<b>1 Safety</b> .....	<b>3</b>	5.4 Duration of Use	13
1.1 Safety and Guideline Signs	3	<b>6 Electrical Connection and Wiring</b> .....	<b>14</b>
1.2 General Guidelines	3	6.1 Earthing Connection	14
1.3 Intended Use	4	6.2 Fuse Element	14
1.4 Handling	4	6.3 Switching Behaviour	15
1.5 User-implemented Protective Measures	4	6.4 Protection Circuit	15
1.6 Dimensioning Other Machine Elements	4	<b>7 Storage</b> .....	<b>16</b>
<b>2 Legal Provisions</b> .....	<b>5</b>	<b>8 Installation</b> .....	<b>16</b>
2.1 Directives, Standards and Regulations Used	5	8.1 Installation Conditions	16
2.2 Liability	5	8.2 Installation (Figs. 1 and 2)	17
2.3 Guarantee	5	8.3 Electrical Connection	18
2.4 Guidelines on CE Identification	6	<b>9 Initial Operation</b> .....	<b>19</b>
2.5 CE Identification	6	9.1 Brake Inspection (before initial operation)	19
2.6 Identification/ Type tag	7	9.2 Brake Test (initial operation)	19
<b>3 Product Description</b> .....	<b>8</b>	<b>10 Maintenance / Inspection / Number of switchings</b> .....	<b>20</b>
3.1 Scope of Delivery / State of Delivery	8	10.1 Number of Switchings	20
3.2 Function	8	10.2 Inspection	20
3.3 Views	9	10.3 Maintenance	20
3.4 Parts List	10	10.4 Cleaning:	21
<b>4 Technical Data</b> .....	<b>11</b>	<b>11 De-installation</b> .....	<b>21</b>
4.1 Guidelines	11	<b>12 Disposal</b> .....	<b>21</b>
4.2 Technical Data	12	<b>13 Malfunctions / Breakdowns</b> .....	<b>22</b>
<b>5 Intended Use</b> .....	<b>13</b>	<b>14 Declaration of Conformity</b> .....	<b>23</b>
5.1 Guidelines for Application	13		
5.2 Limits	13		
5.3 Reasonably Foreseeable Misuse	13		

# Installation and Operational Instructions for ROBA®-linearstop brake Type 382.000.0 Size 10, 20

(E093 20 000 000 4 EN)

## 1 Safety

### 1.1 Safety and Guideline Signs

Symbol	Signal word	Meaning
	<b>DANGER</b>	Designates a directly pending danger. If not avoided, death or severe injuries will be the consequence.
	<b>WARNING</b>	Designates a possibly hazardous situation. If not avoided, death or severe injuries will be the consequence.
	<b>CAUTION</b>	Designates a hazardous situation. If not avoided, slight or minor injuries can be the consequence.
	<b>ATTENTION</b>	Possible property damage can be the consequence.
	<b>Please Observe</b>	Designates tips for application and other particularly useful information. Not a signal word for dangerous or damaging situations.

### 1.2 General Guidelines

#### DANGER



Danger of death! Do not touch voltage-carrying lines and components.

Brakes may generate further risks, among other things:



Hand injuries



Danger of seizure



Contact with hot surfaces



Magnetic fields

**Severe injury to people and damage to objects may result if:**

- the electromagnetic brake is used incorrectly.
- the electromagnetic brake is modified.
- the relevant standards for safety and / or installation conditions are ignored.

#### 1.2.1 Personnel Requirements

**To prevent injury or damage, only professionals and specialists are allowed to work on the components.**

They must be familiar with the dimensioning, transport, installation, initial operation, maintenance and disposal according to the relevant standards and regulations.



Before product installation and initial operation, please read the Installation and Operational Instructions carefully and observe the Safety Regulations. Incorrect operation can cause injury or damage.

- Technical data and specifications (Type tags and documentation) must be followed.
- The correct connection voltage must be connected according to the Type tag and wiring guidelines.
- Check electrical components for signs of damage before putting them into operation. Never bring them into contact with water or other fluids.
- Please observe the EN 60204-1 requirements for electrical connection when using in machines.



Only carry out installation, maintenance and repairs when the brake is in a de-energised, disengaged condition and secure the system against inadvertent switch-on (acc. EN 50110).

#### General Guideline:

During the risk assessment required when designing the machine or system, the dangers involved must be evaluated and removed by taking appropriate protective measures in accordance with the Machinery Directive 2006/42/EC.

Brakes for safety-related applications are to be installed singly or as redundant devices in accordance with the required category, in order to fulfil the required Performance Level (PL<sub>r</sub>) acc. EN ISO 13849. This is in principle the task of the system manufacturer.

## 1.3 Intended Use



Use according to the intended use is prohibited until it has been determined that the machine / system accords with the EC Directive 2006/42/EC (machinery directive).

mayr®-brakes have been developed, manufactured and tested in compliance with the DIN VDE 0580 standard and in accordance with the EU Low Voltage Directive as electromagnetic components. During installation, operation and maintenance of the product, the requirements for the standard must be observed.

ROBA®-linearstop brakes by mayr® power transmission prevent inadvertent dropping or crashing of gravity-loaded axes.

- For applications in, for example, defence technology or medical products, **please contact mayr® power transmission.**
- 
- Not suitable for operation in areas where there is a danger of explosion

The brakes must only be used in the situations for which they are ordered and confirmed. Using them for any other purpose is not allowed.

## 1.4 Handling

**Before installation**, the brake must be inspected and found to be in proper condition (visual inspection). The following are not considered as being representative of a proper condition:

- External damage
- External oiling
- External contamination

The brake function must be inspected both **once attachment has taken place** as well as **after longer system downtimes**, in order to prevent the drive starting up against possibly seized linings.

## 1.5 User-implemented Protective Measures

- Attach a cover to protect **against injury through high temperatures** on the housing in case high temperatures are generated through incorrect wiring, for example increased switching frequency or excessive overexcitation
- Protection circuit: see section **6.4**
- Install additional protective measures **against corrosion** if the brake is subject to extreme ambient conditions or is installed in open air conditions, unprotected from the weather.
- Please cover moving parts to protect **against injury through seizure.**

## 1.6 Dimensioning Other Machine Elements



The effects of the maximum and minimum braking force on the other machine components must be observed in order to provide sufficient dimensioning. The ROBA®-linearstop has (at room temperature) a maximum braking force of 2.5 x brake nominal holding force and a minimum braking force of 1 x brake nominal holding force.

If other brakes are positioned behind the ROBA®-linearstop, and if the braking times of the different brakes overlap, the loads will add up.

# Installation and Operational Instructions for ROBA®-linearstop brake Type 382.000.0 Size 10, 20

(E093 20 000 000 4 EN)

## 2 Legal Provisions

### 2.1 Directives, Standards and Regulations Used

(also to be observed during installation and operation)

2014/35/EU	Low voltage directive
2014/30/EU	EMC Directive
DIN VDE 0580	Electromagnetic devices and components, general specifications
EN ISO 12100	Safety of machinery - General principles for design - Risk assessment and risk reduction
EN ISO 13849-2	Safety of machinery Safety related parts of control systems - Validation
DIN EN 61000-6-4	Interference emission
DIN EN 61000-6-2	Interference immunity

### 2.2 Liability

The information, guidelines and technical data in these documents were up to date at the time of printing. Demands on previously delivered brakes are not valid. Liability for damage and operational malfunctions will not be taken if:

- the Installation and Operational Instructions are ignored or neglected.
- the brakes are used inappropriately.
- the brakes are modified.
- the brakes are worked on unprofessionally.
- the brakes are handled or operated incorrectly.

### 2.3 Guarantee

- The guarantee conditions correspond with the Chr. Mayr GmbH + Co. KG sales and delivery conditions ([www.mayr.com](http://www.mayr.com) → Service → General Terms and Conditions)
- Mistakes or deficiencies are to be reported to *mayr*® power transmission at once!

## 2.4 Guidelines on CE Identification



### **Guidelines on the Declaration of Conformity**

A conformity evaluation has been carried out for the product (electromagnetic safety brake) in terms of the EU Low Voltage Directive 2014/35/EU. The Declaration of Conformity is laid out in writing in a separate document and can be requested if required.

### **Guidelines on the EMC Directive (2014/30/EU)**

The product cannot be operated independently according to the EMC directive.

Due to their passive state, brakes are also non-critical equipment according to the EMC.

Only after integration of the product into an overall system can this be evaluated in terms of the EMC.

For electronic equipment, the evaluation has been verified for the individual product in laboratory conditions, but not in the overall system.

### **Guidelines on the Machinery Directive (2006/42/EC)**

The product is a component for installation into machines according to the Machinery Directive 2006/42/EC.

The brakes can fulfil the specifications for safety-related applications in coordination with other elements.

The type and scope of the required measures result from the machine risk analysis. The brake then becomes a machine component and the machine manufacturer assesses the conformity of the safety device to the directive.

It is forbidden to start use of the product until you have ensured that the machine accords with the regulations stated in the directive.

### **Guidelines on the EU Directive on the Restriction of the Use of Certain Hazardous Substances in Electrical and Electronic Equipment**

The electromagnetic brake as well as the rectifiers / microswitches / proximity switches required for control / self-monitoring fulfil the requirements laid down in the EU Directive 2011/65/EC (RoHS).

(Restrictions on the use of certain hazardous substances, such as lead (0.1 %), mercury (0.1 %), cadmium (0.01 %), hexavalent chromium (0.1 %), polybrominated biphenyls (PBB) (0.1 %), polybrominated diphenylethers (PBDE) (0.1 %))

### **Guidelines on the ATEX Directive**

Without a conformity evaluation, this product is not suitable for use in areas where there is a high danger of explosion.

For application of this product in areas where there is a high danger of explosion, it must be classified and marked according to Directive 2014/34/EU.

## 2.5 CE Identification



Identification according to the low voltage directive 2006/95/EC

# Installation and Operational Instructions for ROBA®-linearstop brake Type 382.000.0 Size 10, 20

(E093 20 000 000 4 EN)

## 2.6 Identification/ Type tag

mayr® components are clearly marked and described on the Type tag:

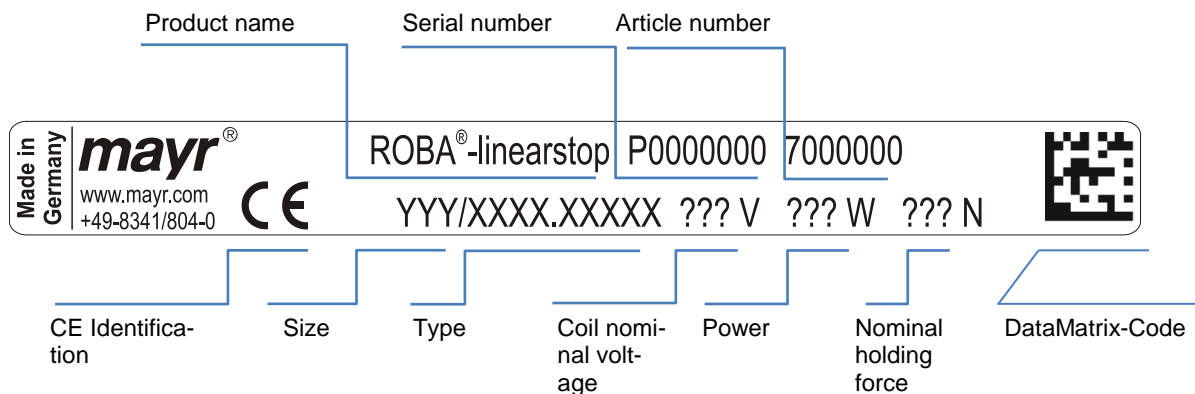

### Serial number

Year	Code
2000	A
2001	B
2002	C
2003	D
2004	E
2005	F
2006	H
2007	J
2008	K
2009	L
2010	M
2011	N
2020	A

Year	Code
2012	P
2013	R
2014	S
2015	T
2016	U
2017	V
2018	W
2019	X

# Installation and Operational Instructions for ROBA®-linearstop brake Type 382.000.0 Size 10, 20

(E093 20 000 000 4 EN)

## 3 Product Description

### 3.1 Scope of Delivery / State of Delivery

- ❑ ROBA®-linearstop brakes are manufacturer-assembled and ready for installation.
- ❑ Please observe the Type tag.
- ❑ Please check the scope of delivery as well as the state of delivery immediately after receiving the goods. *mayr*® power transmission will take no responsibility for belated complaints. Please report transport damage immediately to the supplier. Please report incomplete delivery and obvious defects immediately to the manufacturer.
- ❑ The ROBA®-linearstop is delivered without piston rod. Cap screws serve as transportation lock (7) (3 x red head).

#### ATTENTION

#### The brake could be damaged

Removal of the transportation lock (7) in de-energised condition of the brake can lead to damage

Transportation lock (7) (3 x red head) must be removed after the brake is fitted on the piston rod and energised.

### 3.2 Function

#### 3.2.1 Quiescent Current Principle

The functional principle applied here is the energy-separation principle according to EN ISO 13849-2 Appendix A.2 "List of basic safety principles". The reliable condition is achieved through separation of the energy source, and thus accords with the required safety aspects, for example during power failure or EMERGENCY STOP.

The spring-loaded, enclosed **ROBA®-linearstop**, which can be opened electrically, clamps a piston rod steplessly and backlash-free.

Due to the spring-loaded system, the fail-safe principle can be guaranteed, the **ROBA®-linearstop** works as a **safety brake**.

- ❑ The brake clamping element is pulled against the spring through application of the voltage. The piston rod can be moved (Fig. 1).
- ❑ The spring has an effect on the clamping element of the brake through switch-off the voltage. The piston rod is clamped (Fig. 2).

The max. permitted sliding speed is 2 m/s.

Higher speeds on request!



#### Please Observe!

Before brake closure, the collet must enclose the piston rod completely.

If the piston rod ends in the collet, the clamping element might get damaged when actuating the brake!

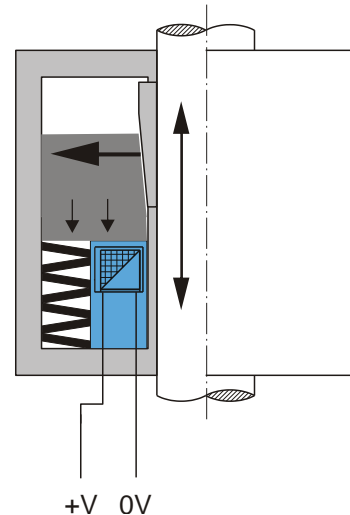

Illustration 1 Movable piston rod on application of the coil nominal voltage

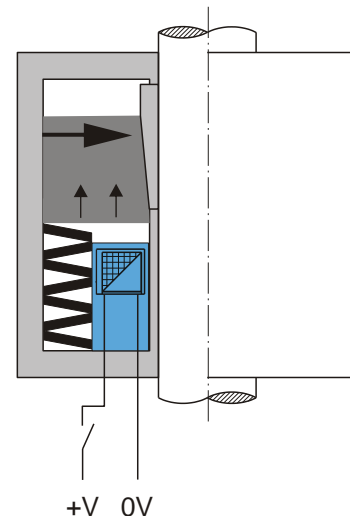
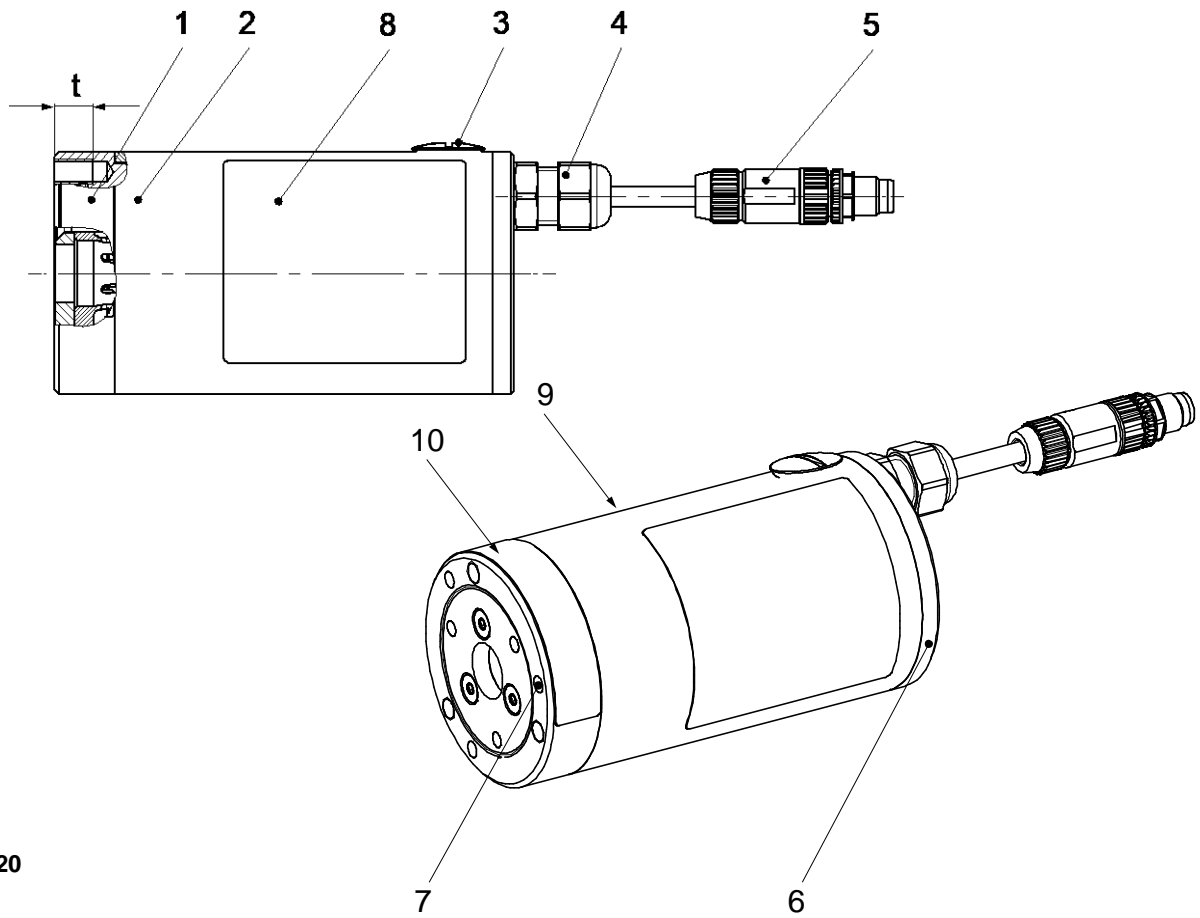

Illustration 2 Clamped piston rod on disconnection of the coil nominal voltage

# Installation and Operational Instructions for ROBA®-linearstop brake Type 382.000.0 Size 10, 20

(E093 20 000 000 4 EN)

## 3.3 Views



Size 20

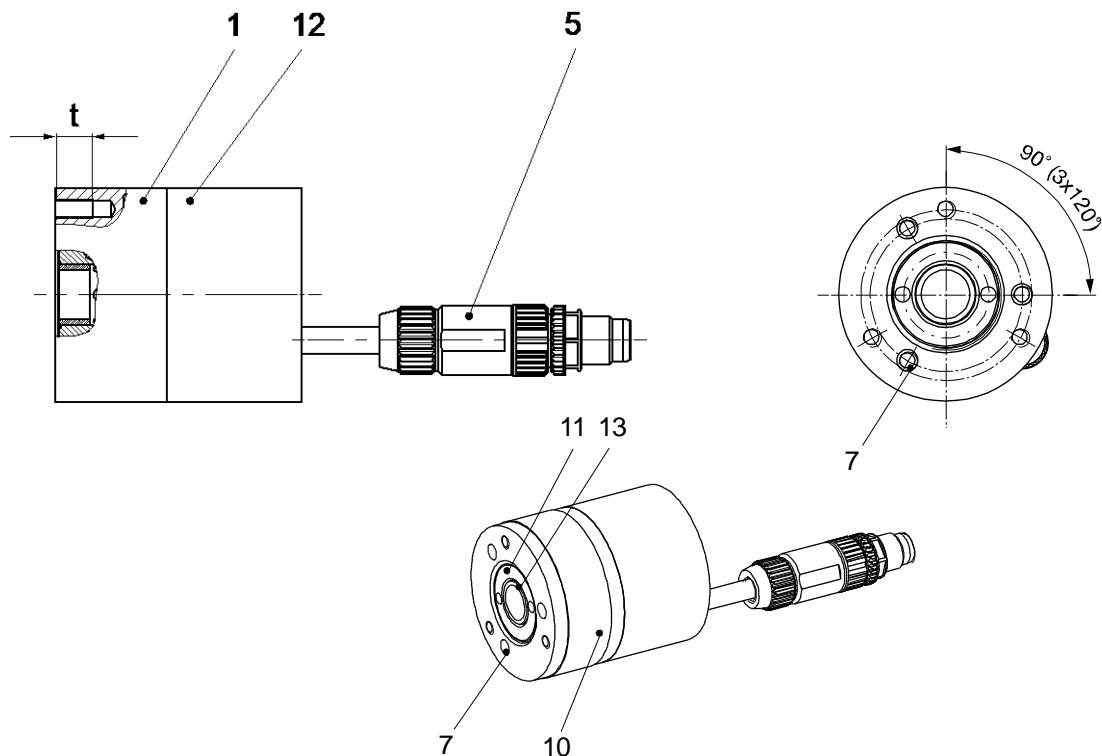

Size 10

# Installation and Operational Instructions for ROBA®-linearstop brake Type 382.000.0 Size 10, 20

(E093 20 000 000 4 EN)

## 3.4 Parts List

(Only use *mayr*® original parts)

Item	Name
1	Adaptor
2	Housing
3	Screw plug
4	Cable gland
5	Plug-in connection M8
6	Cover
7	Transportation lock (3x red head)
8	Guideline sign, transportation lock
9	Guideline sign overexcitation/power reduction
10	Type tag
11	Collet
12	Coil carrier
13	Plain bearing

## 4 Technical Data

### 4.1 Guidelines

#### 4.1.1 Application Conditions



The stated values are guideline values which have been determined in test facilities. It may be necessary to carry out your own tests for the intended application. When dimensioning the brakes, please remember that installation situations, permitted friction work and braking distances as well as general ambient conditions can all affect the given values.

- Mounting dimensions and connection dimensions must be adjusted according to the size of the brake at the place of installation.
- The magnetic coils are designed for a relative duty cycle of 100% on holding voltage.
- Temperatures of up to 60 °C can occur on the brake housing at an ambient temperature of 20 °C.  
In higher ambient temperatures the brake housing temperature will also increase. Protective measures must be undertaken customer-side against contact burns.
- If the maximum switching frequency (see section **4.2**) is exceeded, the brake may overheat. The required magnetic force can no longer be reached. The brake first has to cool down
- The surfaces of the outer components have been phosphated manufacturer-side to form a basic corrosion protection. For brake applications outdoors where the device is subject to weather influences or extreme environmental conditions, additional protective measures, such as for example protective paint, must be provided.

#### 4.1.2 Ambient temperature

–5 °C up to +55 °C, non-condensing

The Technical Data refers to the stated temperature range.

#### 4.1.3 Class of Insulation F (+155 °C)

The insulation components on the magnetic coils are manufactured at least to class of insulation F (+155 °C).

#### 4.1.4 Protection

**(mechanical) IP54:** When installed, dust-proof and protected against contact as well as against water spray from any direction (dependent on customer-side mounting method).

**(electrical) IP54:** Dust-proof and protected against contact as well as against water spray from any direction.

#### 4.1.5 Noise Emissions

The ROBA®-linearstop is not noise-reduced. When the armature disk is switched, the impact pulse from the armature disk onto the coil carrier or the armature disk onto the rotor generates a switching noise which can reach approx. 70 dB(A). The brake is not suitable for use in noise-sensitive applications.

#### 4.1.6 Installation Position

The ROBA®-linearstop can be operated in any installation position.

#### 4.1.7 Pre-requisites for Product Application

Compare the limit values stated in these Installation and Operational Instructions with the actual application, e.g.

- Clamping / braking forces
- Braking distance
- Masses
- Temperatures etc.

# Installation and Operational Instructions for ROBA®-linearstop brake Type 382.000.0 Size 10, 20

(E093 20 000 000 4 EN)

## 4.2 Technical Data

				Size	
				10	20
Nominal holding force <sup>1)</sup> (minimum holding force)		F <sub>Nenn</sub>	[N]	70	180
Electrical Power		P <sub>N</sub> <sup>2)</sup>	[W]	5.9	7.9
		P <sub>O</sub> <sup>3)</sup>		94	126
		P <sub>H</sub> <sup>4)</sup>		2.6	3.5
Electrical voltage	Coil nominal voltage	U <sub>N</sub>	[VDC]	6	
	Overexcitation voltage	U <sub>O</sub>		24	
	Holding voltage	U <sub>H</sub>		4	
Weight			[kg]	0.25	0.96
Ambient temperature			[°C]	-5 to +55	
Max. switching frequency		1/min		3	
Brake switching time		t <sub>50</sub>	[s]	0.020	0.030
Transportation lock Pos. 7	Max. tightening torque		[Nm]	2	

<sup>1)</sup> Minimum holding force when the brake is de-energised, and with the piston rod dry or moistened with mineral oil.

<sup>2)</sup> Coil nominal capacity

<sup>3)</sup> Coil capacity on overexcitation (0.150 s) U<sub>O</sub> = 4 x U<sub>N</sub>. ( see section **6**).

<sup>4)</sup> Coil capacity at holding voltage U<sub>H</sub> = 0.5 x U<sub>N</sub>

## 5 Intended Use

See also section [1.3](#)

### 5.1 Guidelines for Application

- Please observe the correct dimensioning of clamping or braking force, friction work and switching frequency at an EMERGENCY STOP for safe holding of the mass and safe compliance of the required braking distance.
- Static application
  - Holding and clamping in case of power failure
  - on cable breakage
  - EMERGENCY STOP
- The stated switching times can only be achieved using the respective correct electrical wiring. This also refers to the protection circuit for brake control and the response delay times of all control components.
- Temperatures over 80 °C on the brake housing when the machine is in use may reduce the magnetic force. Brake does not release properly.
- Application in clean environments (penetration of coarse-grained dust and liquids such as oils can have a negative effect on the braking function).
- Application in enclosed buildings (In tropical regions, in high humidity with long downtimes and sea climates only after taking special measures).

Please contact **mayr®** power transmission.



Brakes which are to be used in safety-related applications must be selected, dimensioned and positioned according to the risk assessment DIN EN 12100 and other standards and regulations applicable to the special application. This is in principle the task of the system manufacturer/user.

### 5.2 Limits

- The brake is not suitable for use in oily or severely contaminated environments
- The brake is not suitable for application in high ambient temperatures >55 °C

### 5.3 Reasonably Foreseeable Misuse

The following uses are prohibited and may generate hazards.

- Any opening of the screws on the housing.
- The maximum switching frequency is exceeded
- Transportation locks will not be removed
- Brake is used in oily or heavily contaminated surroundings
- The overexcitation time of 0.150 s is exceeded
- No overexcitation

### 5.4 Duration of Use

20 years or on reaching the T10d (for definition, see EN ISO 13849-1) duration of use.

## 6 Electrical Connection and Wiring



The brake must only be operated with overexcitation. The required overexcitation time is 0.150 s.



**Recommendation:**  
Use the following *mayr*® DC voltage modules for the respective brake size:

DC voltage module	Art.No.
ROBA®-brake-checker plus DC Type 028.600.2	8288568

**See Installation and Operational Instructions for ROBA®-brake-checker plus DC B.028600.2**

DC current is necessary for operation of the brake. The coil nominal voltage is indicated on the Type tag as well as on the brake body and is designed according to the DIN IEC 60038 ( $\pm 10\%$  tolerance).

Please follow the exact connections according to the section **8.3**. The manufacturer and the user must observe the applicable regulations and standards (e.g. DIN EN 60204-1 and DIN VDE 0580). Their observance must be guaranteed and double-checked!

### 6.1 Earthing Connection

The brake is designed for Protection Class I. This protection covers not only the basic insulation, but also the connection of all conductive parts to the protective conductor (PE) on the fixed installation. If the basic insulation fails, no contact voltage will remain. Please carry out a standardised inspection of the protective conductor connections to all contactable metal parts!

### 6.2 Fuse Element

Short-circuits or earth short-circuits can lead to DC voltage module failures. After fuse elements have reacted to a malfunction, the DC voltage module must be checked for functional and operational safety (overexcitation voltage, switch-off voltage, response delay time and holding voltage). The same procedure is to be carried out after brake failure.



**Recommendation:**  
In case of failure of the DC voltage module, please protect the brake from permanent overexcitation:

**Measure:**  
Installation of a circuit breaker (characteristic C) into the power supply cable of the DC voltage module.  
The measure fulfills the device fuse requirements for the DC voltage module.

ROBA®-linearstop Size 10:  
Circuit breaker = 1.0 A

ROBA®-linearstop Size 20:  
Circuit breaker = 1.6 A

## 6.3 Switching Behaviour

The reliable operational behaviour of a brake is to a large extent dependent on the correct wiring and the temperature.

### Key and Calculations:

$P$  [W] RMS coil capacity dependent on switching frequency <sup>1)</sup>, overexcitation, reduction in capacity and duty cycle

$$P = \frac{P_0 \times t_0 + P_H \times t_H}{T}$$

$P_N$  [W] Coil nominal capacity (Technical Data, type tag)

$P_0$  [W] Coil power on overexcitation (Technical Data)

$$P_0 = \left(\frac{U_0}{U_N}\right)^2 \times P_N$$

$P_H$  [W] Coil power on power reduction (Technical Data, type tag)

$$P_H = \left(\frac{U_H}{U_N}\right)^2 \times P_N$$

$t_0$  [s] Overexcitation time (0.5 s)

$t_H$  [s] Holding time

$t_{on}$  [s] Time with voltage

$t_{off}$  [s] Time without voltage

$T$  [s] Total time ( $t_0 + t_H + t_{off}$ )

$U_0$  [V] Overexcitation voltage ( $\approx 4 \times U_N$ )

$U_H$  [V] Holding voltage ( $\approx 0.5 \times U_N$ )

$U_N$  [V] Coil nominal voltage

$I_0$  [A] Overexcitation current

$I_N$  [A] Nominal current

1) See section [4.2](#)

### 6.3.1.1 Time Diagram:

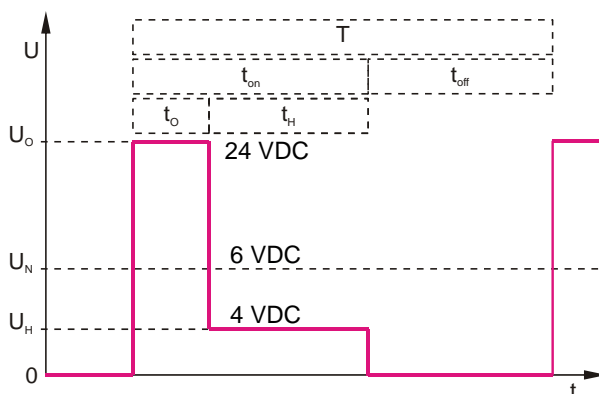

### Please Observe!

#### Safety switch-off

In applications with a necessarily short switching time for short braking distances and fast take-over of loads, reliable DC-side switch-off is required e.g. through redundant, monitored contactors (see schematic wiring diagram).

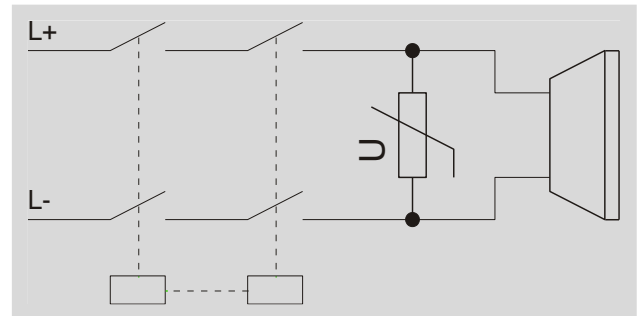

Schematic wiring diagram

## 6.4 Protection Circuit

When using DC-side switching, the coil must be protected by a suitable protection circuit according to VDE 0580, which is integrated in *mayr*®-rectifiers. To protect the switching contact from consumption when using DC-side switching, additional protective measures are necessary (e.g. series connection of switching contacts). The switching contacts used should have a minimum contact opening of 3 mm and should be suitable for inductive load switching. Please make sure on selection that the rated voltage and the rated operating current are sufficient. Depending on the application, the switching contact can also be protected by other protection circuits (e.g. *mayr*®-spark quenching unit), although this may of course then alter the switching times.

The following parameters can be changed through suitable adaptations of the protection circuit.

- Contact lifetime
- Switching times
- Voltage peaks or level of switch-off voltage

Please contact *mayr*® power transmission.

## 7 Storage

### 7.1.1 Brake Storage

- Store the brakes in a horizontal position, in dry rooms and dust and vibration-free.
- Relative air humidity < 50 %.
- Temperature without major fluctuations within a range from 10 °C up to +40 °C.
- Do not store in direct sunlight or UV light.
- Do not store aggressive, corrosive substances (solvents / acids / lyes / salts etc.) near to the brakes.

For longer storage lasting more than 2 years, special measures are required.

► Please contact **mayr®** power transmission.

## 8 Installation

### 8.1 Installation Conditions

Please observe before installation!

#### 8.1.1 General



**Please Observe!**  
The piston rod must only be loaded in the direction of motion.

- The brake is delivered manufacturer-assembled ready for installation



**Please Observe!**  
Leave the brake in its installed condition!

### 8.1.2 Piston Rod

Requirements on the piston rod

- For brake installation, we recommend an insertion chamfer on the piston rod of min. 3 x 20°.
- The piston rod should be installed at one end as a floating bearing.
- We recommend to stress the piston rod with tension.



**Please Observe!**

Please pay attention to the buckling safety on pressure-loaded piston rods!

Please observe the stroke length, the load and cylinder mounting to prevent bending or buckling of the piston rod in any stroke position.

$$F_{\max} = 2.5 \times F_{\text{Nenn}}$$



**Please Observe!**

The **ROBA®-linearstop** function can only be guaranteed on a proper rod surface.

#### Rod quality

Steel, hard chromium-plated	
Layer thickness	at least 20 µm
Diameter tolerance	f7
Surface quality	Ra < 0.4 µm
Yield point	min. 400 N/mm <sup>2</sup> (e.g. C45)

or

Steel, hardened	
Hardness testing	at least HRC 60
Tolerance field	f7
Surface quality	Ra < 0.4 µm
Yield point	min. 400 N/mm <sup>2</sup> (e.g. C45)

**CAUTION**



The clamping effect might get influenced by friction value-reducing materials, such as tough greasy lubricants, greases or separating agents - please clean, if necessary; see section **10.4**

# Installation and Operational Instructions for ROBA®-linearstop brake Type 382.000.0 Size 10, 20

(E093 20 000 000 4 EN)

## 8.2 Installation (Figs. 1 and 2)

### 8.2.1 Pre-requisites

- Unpack the brake
- Check for completeness
- Check the data on the Type tag
- Visual inspection (e.g. after longer storage period)

### 8.2.2 Preparation

- Have the necessary tools ready
  - Spanners etc.
  - Torque wrenches
- Provide fixing screws (not included in the standard scope of delivery)

Fixing screw sizes and tightening torques				
Size	Thread	Tightening torque	Property class	Screw-in depth t
10	3 x M3	1.3 Nm	8.8	6 mm
20	3 x M5	5.1 Nm	8.8	8 mm

All tightening torques are recommendations only. These data do not relieve the user from checking the data regarding the actual installation situation.

### 8.2.3 Installation Procedure



The piston rod support (Fig. 1 Item 5) and the piston rod (Fig. 1 Item 3) (customerside) must be exactly aligned with one another. Max. Deviation to 0.3 mm = 0.1 mm

1. Position the mounting flange (Fig. 2 Item 1) (customer-side) at the fixed bearing of the piston rod.
2. Connect the brake acc. the Wiring Diagram **9.3**
3. Energise the brake



The brake only opens on overexcitation (see section **6**).



The brake is opened at the factory through the transportation lock (7), and can be pushed onto the piston rod without being energised.

4. Push the brake onto the piston rod.

5. Unscrew and remove the transportation lock (7)

#### ATTENTION

#### The brake could be damaged

Removal of the transportation lock (7) in de-energised condition of the brake can lead to damage

Transportation lock (7) (3 x red head) must be removed after the brake is fitted on the piston rod and energised.

6. Bring the brake up to contact to the mounting flange (customer-side).
7. Screw in the fixing screws (without torque).
8. Screw-securing with Loctite 243



#### Please Observe!

Before brake closure, the collet must enclose the piston rod completely.

If the piston rod ends in the collet, the clamping element might get damaged when actuating the brake!



#### Please Observe!

To check the angular misalignment of the mounting flange (Fig. 2 Item 1) to the brake (Fig. 2 Item 4), the distance of the brake to the mounting flange at the circumference of the brake is measured. Maximum gap B = 0.05 mm

9. Switch the brake in de-energised state, thereby placing it under tension (centring).
10. Tighten the fixing screws using the tightening torque.



#### CAUTION Load crash possible

The brake will not work with the transportation lock (7) screwed in.

The transportation locks (7) must be removed.

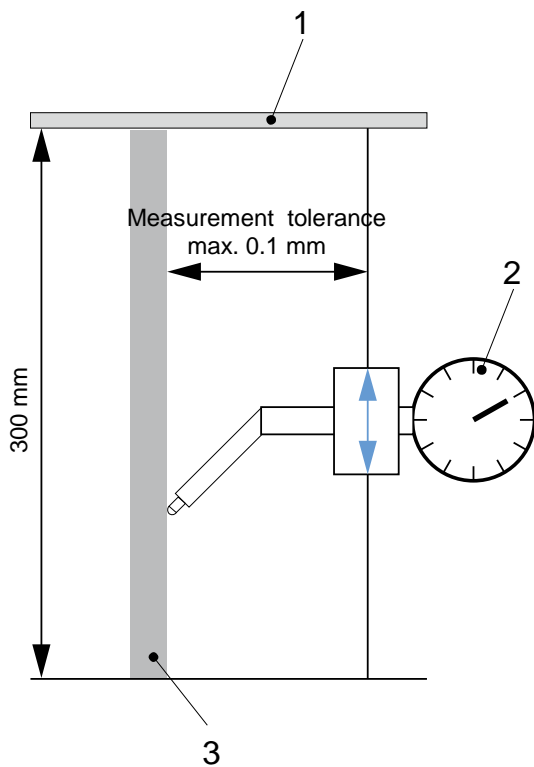

**Fig. 1:** Alignment piston rod

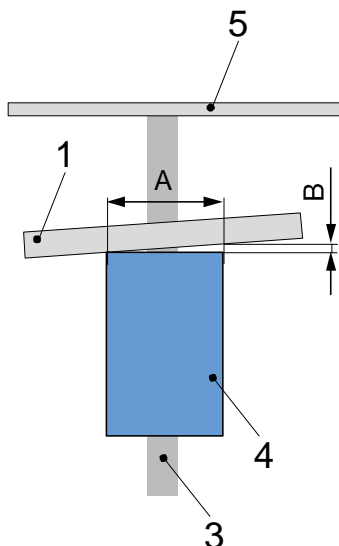

**Fig. 2:** Alignment of brake to the flange

Item	
1	Mounting flange
2	Dial gauge
3	Piston Rod
4	Brake
5	Piston rod support

### 8.3 Electrical Connection

**DANGER** Carry out electrical connection only in de-energised condition.  
**Electrical shock possible.**  
Only trained personnel should carry out the connection.

#### 8.3.1 Wiring diagram brake

Assignment round plug	
Pin 1: Black	+VDC
Pin 3: Brown	-VDC

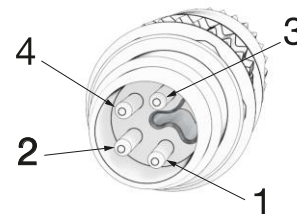

## 9 Initial Operation

### 9.1 Brake Inspection (before initial operation)

- ❑ Check all fixing screws for the required tightening torque.
- ❑ Function test after completed assembly and electrical connection of the brake

### 9.2 Brake Test (initial operation)

#### CAUTION



During the Brake Test danger to personnel and damage to machines cannot be ruled out in case of malfunctions (incorrect installation, control errors etc.).

Do not enter the danger zone.

Possibly take measures for catching or damping the load.

Check dimensioning!

#### 9.2.1 (Static) Brake Inspection

- ❑ On vertical axes, a brake inspection is carried out via load assumption or via the drive.



#### Recommendation!

Test the brake using the nominal holding force or the maximum load mass.

#### 9.2.2 Regular Function Inspection (static)

- ❑ Depending on the application requirements, we recommend carrying out regular braking force inspections (depending on the application), e.g. check the static holding force 1 x per shift with nominal holding force or with maximum load mass.



#### Recommendation!

The holding force may be reduced by friction value-reducing materials. If the brake during the functional inspection does not achieve the nominal holding force, repeat using 90 % of the nominal holding force and clean the piston rod at the next opportunity (see section **10.4**).

## 10 Maintenance / Inspection / Number of switchings

### 10.1 Number of Switchings

The ROBA®-linearstop is designed for a switching frequency of up to 200.000 switching actions.



At a switching frequency > 200.000 please contact **mayr®** power transmission.

### 10.2 Inspection

Check the condition

Measure	Condition		Interval	Implementa- tion
Visual inspection	Piston Rod	Check the piston rod for wear.	After every EMERGENCY STOP occurrence.	Qualified per- sonnel
	Wear indicators	Nominal holding force is not reached (slipping). Replace brake	To be determined by ma- chine operator depending on the installation situation If you have any questions, please contact <b>mayr®</b> transmission.	<b>mayr® power transmission</b>

### 10.3 Maintenance

The ROBA®-linearstop is mainly maintenance-free.

Measure	Note/comment	Interval	Implementa- tion
Functional Inspection	Carry out a regular functional inspection	see section <b>9.2.2</b>	Qualified per- sonnel
Check the piston rod	The piston rod must be checked regularly for contamination with friction value-reducing materials; it must be cleaned, if necessary (see section <b>10.4</b> ).  Special measures may be necessary if the de- vice is subject to large amounts of dirt or dust or is operating in extreme ambient conditions. <b>Please contact <b>mayr®</b> power transmission.</b>	at least every 6 months	



Should the ROBA®-linearstop no longer meet the required characteristics or should the necessary safety for work on the machine or system no longer be given, the brake must be checked at **mayr® power transmission** and, if necessary, professionally repaired and approved.

## 10.4 Cleaning:

Clean the piston rod using ethyl alcohol.

## 11 De-installation

### WARNING Load crash possible



The brake must be load-free.  
Please check that it is load-free before  
de-installation.

- Provide security in the danger zone.
- Support the load

### CAUTION Please observe the own weight of the brake



The brake may drop during lifting / disas-  
sembly.

The consequences may be crush injuries  
and impact injuries.

De-installation takes place by following the "Installation  
procedure" section **8.2.3** backwards.



### Please Observe!

Prior to the brake being pushed from the  
piston rod, the transportation lock (7)  
must be screwed in.

- Completely screw in the transporta-  
tion lock (7) (3 screws) by hand.

## 12 Disposal

Our electromagnetic brake components must be disposed  
of separately as they consist of different materials. Please  
also observe the relevant authority regulations. Code num-  
bers may vary according to the disassembling process  
(metal, plastic and cables).

### Electronic components

(Rectifier / ROBA®-switch / proximity switch):

Products which have not been disassembled can be dis-  
posed of under Code No. 160214 (mixed materials) or  
components under Code No. 160216, or can be disposed  
of by a certified disposal firm.

### Brake bodies made of steel pads with coil /cable and all other steel components:

Steel scrap (Code No. 160117)

### All aluminium components:

Non-ferrous metals (Code No. 160118)

### Seals, O-rings, V-seals, elastomers:

Plastic (Code No. 160119)

# Installation and Operational Instructions for ROBA®-linearstop brake Type 382.000.0 Size 10, 20

(E093 20 000 000 4 EN)

## 13 Malfunctions / Breakdowns

Malfunction	Possible Causes	Solutions	Implementation
<b>Brake does not release</b>	Incorrect voltage, no DC voltage	Check voltage, observe the wiring guidelines	Qualified personnel
	Defective electrical wiring	Check electrical wiring	
	Defective coil, coil is thermally overloaded	Check coil capacity, check insulation resistance	
	Wear too big	Send the device	<b>mayr® power transmission</b>
<b>Brake does not brake</b>	Transportation lock (7) ist not removed	Remove the transportation lock (7)	Qualified personnel
	Piston rod too small	Check dimensioning, check technical data	
	Defective electrical wiring	Check electrical wiring	
<b>Braking distance too long</b>	Friction value-reducing materials on the piston rod	Clean the piston rod	Qualified personnel
	Incorrect dimensioning	Check dimensioning, check technical data	



Mayr® power transmission will take no responsibility or guarantee for replacement parts and accessories which have not been delivered by mayr® power transmission, or for damage resulting from the use of these products.

14 Declaration of Conformity

# EC – Declaration of Conformity

TRANSLATION

In terms of the EC Directive 2006/42/EC (machinery directive) relating to machinery we

**Chr. Mayr GmbH + Co. KG**  
**Eichenstraße 1**  
**D-87665 Mauerstetten**

declare that the products stated below have been developed, constructed and manufactured in sole responsibility and in conformity with the above mentioned EC Directive.

**Electromagnetic piston rod brake**

Product	Sizes	Types	ASRI
ROBA®-linearstop	10, 20	382.____	1,2,3 *

Year of manufacture: see product label

Applied Standards, Regulations and Inspections (ANVP)

1	DIN EN ISO 12100	03/2011	Safety of machinery - General principles for design	2006/42/EG
2	DIN EN ISO 13849-1	12/2008	Safety of machinery – Safety related parts of control systems	2006/42/EG
3	DIN VDE 0580	11/2011	Electromagnetic devices and components, general specifications	2014/35/EU

**Note EMC Directive (2014/30/EU)**

The products listed are not independently operable products within the meaning of the EMC Directive. Due to their passive state, brakes and clutches are also non-critical equipment according to the EMC. Only after integration of the product into an overall system can this be evaluated in terms of the EMC. For electronic equipment, the evaluation has been verified for the individual product in laboratory conditions, but not in the overall system.

X	* EC-Machinery directive 2006/42/EC
	** EU-Low voltage directive 2014/35/EU (is covered by the machinery directive)
	*** Electromagnetic compatibility directive 2014/30/EU

Representatives name for the documentation: Quality Management

Mauerstetten, August 22, 2018  
Ort und Datum / place and date

Dipl. Ing. (FH) / graduate engineer  
Geschäftsführer / Managing Director  
Günther Klingler